

****THERMOFUSIBLE MEMBRANES**

COLPHENE FLAM 180, COLPHENE FLAM HR
and COLPHENE HR SP:
Seal all terminations (horizontal and vertical) with
trowel with a round end.

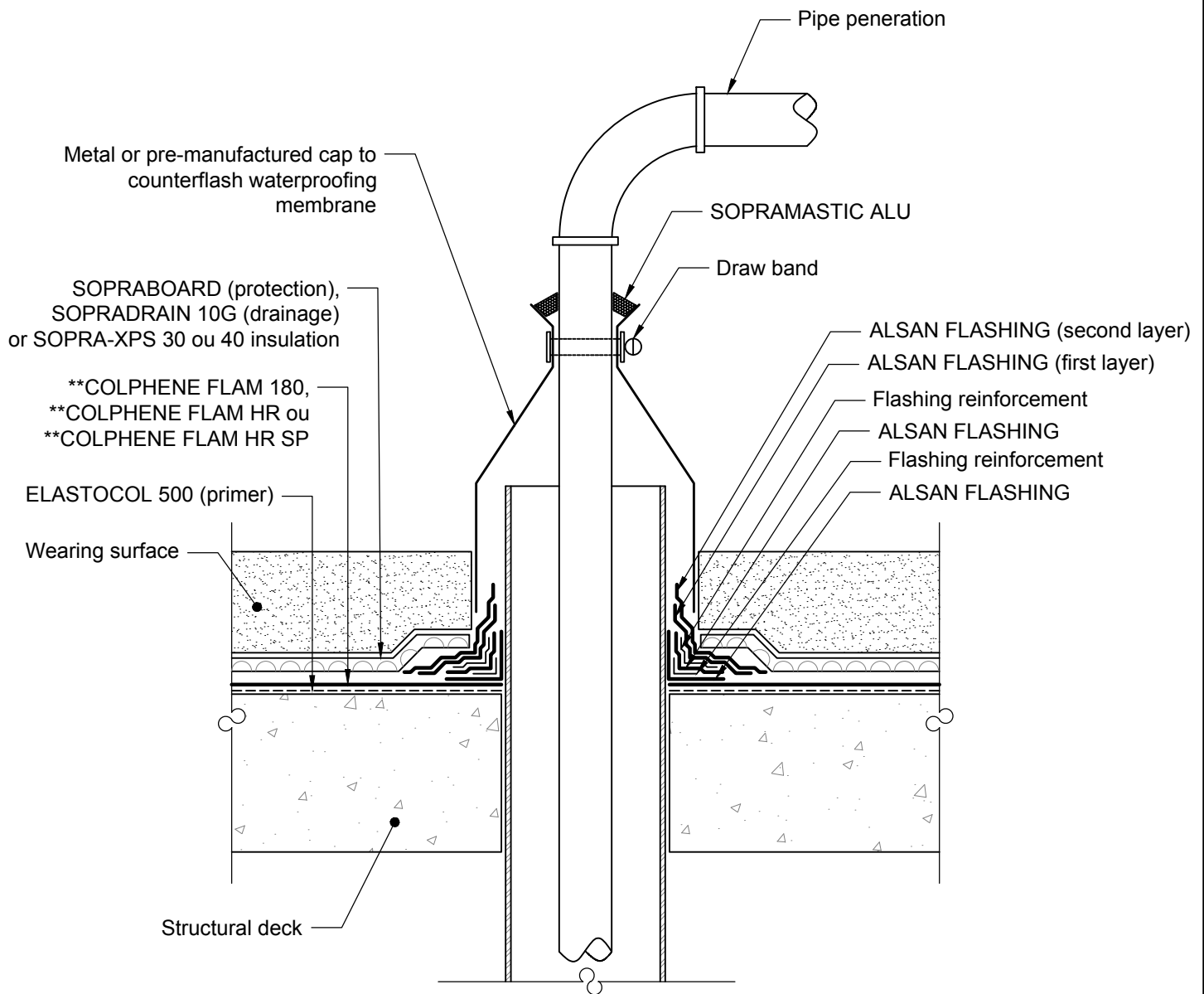

COPYRIGHT 2017 SOPREMA



1688, J-B Michaud
Drummondville, QC J2C 8E9
WWW.SOPREMA.CA

TITLE: PLAZA DECK / PIPE PENETRATION

PROJECT:	DRAWING NUMBER:	
SCALE: N.T.S.	DATE: OCTOBER 2017	BGW12

Note :
Penetrations to be spaced 300 mm (12") minimum apart and 300 mm
(12") minimum from walls and curbs.